

DONG-A CABLE GLAND ASSEMBLY INSTRUCTIONS

ADAPTOR(DAAD) and REDUCER(DARE) TYPES

Dual certified Ex'd' & Ex'e' by BASEEFA, UK



※ Special Conditions for Safe Use.

- 1 . If the adapters are intended for use with increased safety (Ex e) or dust tight (Ex tD) enclosures, the threads should be sealed to maintain an IP66 rating in accordance with IEC60079-14
- 2 . Only one thread adaptors is permitted for each cable entry, blanking elements shall not be used with adaptors.
Example : M20(M) to M25(F) is permitted and M20(M) to M32(F) is not permitted.

- Dong-A Adaptors(DAAD Type) and Reducers(DARE Type) offer for both industrial and hazardous area applications, which provide a means of connection between cable glands and the equipment with dis-similar thread sizes or types.



● Fitting Installation Procedure :

Checking both sizes of the hole of the equipment and the cable gland and choice suitable adaptors or reducers.

(See attached tables of a wide range of thread conversion adaptors and reducers)

To ensure ingress protection ratings are maintained a sealing washer or non-setting compound may be used in accordance with IEC60079-14. For flameproof application (Ex d) the user must ensure that a minimum of 5 complete threads are engaged, particularly if supplementary thread sealing is used.'

Tighten up the adaptor or reducer using a wrench or spanner until resistance is felt .

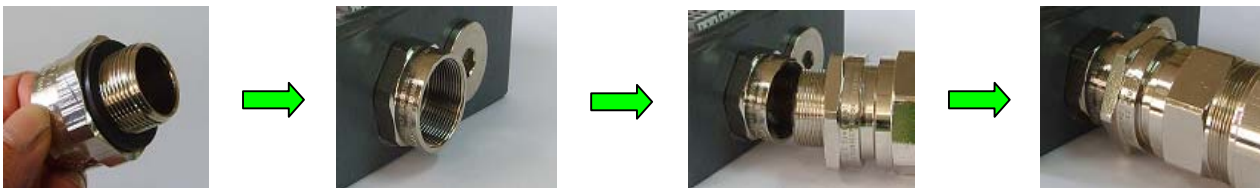

● ATEX MARKING - IEC & CENELEC (Group II)

ATEX Marking for Adaptors & Reducers :

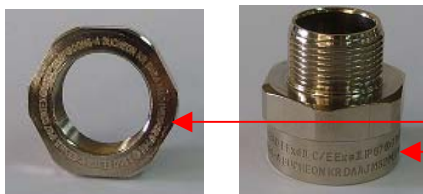

Explosion Protection

Apparatus sub-group permitted Protection Concept

Gas&Dust Group

The symbol for each type of protection technique used, equipment certificate issued by an EC approved body.

Ex II 2GD Ex d IIC Ex e II Ex tD A21 Baseefa08ATEX0019XJEC ExBAS08.0008X
IP66 DAAD-Mxxxx xx(M) X xx(F) 2011/03 DONG-A Bucheon Korea €€1180

Ingress of protection

Type&cat,number

Manufactured year/month

Manufactured address

Visit our web site at www.dongabestech.com



DONG-A BESTECH CO.,LTD

13-16 Samjeong-dong, Ohjeong-ku, Bucheon-city, Kyunggi-do, Korea

Sales Tel. 82-32-675-0081(ext,201)
Technical Tel. 82-32-675-0081(ext,300)



Safety First !

E-mail : sales@dongabestech.com